

# Free LOCAL AREA Guide

## Orange County, FL



LincolnMarketing  
www.lincolnmktg.com

**25+ YEARS  
OF EXCEEDING  
EXPECTATIONS!**

**PA**  
&  
**ROOFING AND  
SHEET METAL**

**COVERING FLORIDA  
ONE ROOF AT A TIME**  
**RESIDENTIAL REPAIRS  
AND REPLACEMENTS**



**407-650-9541**

4495 35th Street, Orlando, FL 32811

3901 SW 47th Ave, STE 400 Davie, FL 33314 • **954-933-2095**

**PA-ROOFING.COM** • CONTACT US TODAY FOR FREE ESTIMATE

# WELCOME TO DELICIOUS



Stop by Culver's of Orlando  
4591 POWER CENTER LANE  
OPEN DAILY 10 a.m.  
321-247-5704



OUR HOURS OF OPERATION  
SEVEN DAYS A WEEK OUR DINING ROOM CLOSSES AT 10  
SUNDAY THROUGH THURSDAY OUR DRIVE-THROUGH CLOSSES AT 11  
AND ON FRIDAY AND SATURDAYS OUR DRIVE-THROUGH CLOSE AT 12.



## Respect and Protect



Help protect  
manatees and  
Adopt-A-Manatee®  
today!



1-800-432-JOIN (5646)  
savethemanatee.org  
Photo © David Schrichte

Don't Just Add  
Years to Your Life.  
Add Life to  
Your Years.

Embrace  
a healthier,  
fuller life with  
VIPcare and  
SaludVIP.

Primary care  
for 65+.

Schedule your appointment and  
start living your best life

**(407) 904-4240**



FEEL THE DEL-AIR DIFFERENCE



SCAN NOW TO SCHEDULE!



FREE

A/C Replacement | Inspection with Estimates | Paid Repair

RESIDENTIAL • NEW CONSTRUCTION

Air Conditioning Sales, Install, Repairs & Maintenance
Heat Pumps • Electrical • Water Heaters • Plumbing



DELAIR.com
SERVICE@DELAIR.com



407.768.1902

©2024, DEL-AIR HEATING, AIR CONDITIONING & REFRIGERATION, LLC. LIC# EC13010622 CAC1822274 CFC057524

TABLE OF CONTENTS

- 2-4 Local Area Events
5 Resident Services
6 County History
7-8 County Communities
12-15 Parks & Recreation
20 FWC License Centers
22 Fishing Fees
23 Boat Ramps/ Fishing Piers
30-33 Area Attractions



Orange County

Scan the QR Code to go to the county page.



This free publication is made possible by the advertisers and other local agencies and may not be reproduced. Please support the local advertisers on this publication. Comments and/or suggestions may be directed to: info@lincolnmarketing.us

View this publication online at www.lincolnmarketing.us

# Local Area Events

## JANUARY

- ▶ Annual Camellia Show - Winter Park
- ▶ Annual Unity Heritage Festival - Winter Park
- ▶ BBQ Festival - Orlando
- ▶ Celebrate Martin Luther King Jr - Winter Garden
- ▶ Cruz-N-Car Show - (3rd Sat)- Winter Garden
- ▶ Festival of the Arts - (Thru Feb) -Orlando
- ▶ Fridays on the Plaza - Year Round (Fridays) - Winter Garden
- ▶ Get Down Downtown - Year Round - Maitland
- ▶ Maitland Farmers Market -(Sundays) - Year Round
- ▶ Maitland PD Family Fun Day
- ▶ Martin Luther King Jr Celebration - Orlando
- ▶ Park Ave 5K - Winter Park
- ▶ Rock The Universe - Orlando
- ▶ Three Kings Celebrations - Orlando
- ▶ Wesleys Annual Virtual Walk - Winter Garden
- ▶ Winter Garden Farmers Market - Year Round

## FEBRUARY

- ▶ Blues & BBQ - Winter Garden
- ▶ Food & Wine Festival - Orlando
- ▶ Inva 5K- Winter Park
- ▶ Magic 5K, 1 Mile & Kids Run - Orlando
- ▶ Mardi Gras Celebrations - Orlando
- ▶ Resonate Festival - Winter Park
- ▶ Senior Prom 55+ - Winter Park
- ▶ Seven Seas Festival - Orlando
- ▶ Silver Spurs Rodeo - Orlando
- ▶ Take Over the Trails Day - Winter Garden
- ▶ Valentines Day Celebrations - Orlando
- ▶ Winter Garden Music Festival

## MARCH

- ▶ Annual Celtic Festival - Winter Garden
- ▶ Apopka Fair
- ▶ Community Garage Sales - Winter Park
- ▶ Evening at the Pops - Winter Garden
- ▶ Florida Strawberry Festival - Orlando
- ▶ Flower & Garden Festival - Orlando
- ▶ Mad Soul Music & Art Festival - Orlando
- ▶ Orlando Philharmonic Spring Pops - Winter Park
- ▶ St. Paddies Day Winter Garden Community Pickleball Fest
- ▶ St. Patricks Day Parade - Winter Park
- ▶ Winter Park Sidewalk Art Festival

## APRIL

- ▶ Apopka Art & Foliage Festival
- ▶ Bike to Work Day - Orlando
- ▶ Chalkin' it Up Sidewalk Art Contest - Winter Garden
- ▶ Cruz-n-Car Show - 3rd Saturday - Winter Garden
- ▶ Dog Fest - Winter Park
- ▶ Easter on the Avenue - Winter Park
- ▶ Maitland Jazz & Blues Festival
- ▶ Run for the Trees Jeanette Genius McKean Memorial 5K - Winter Park
- ▶ Spring Fever in the Garden - Winter Garden
- ▶ Winter Park Paint Out

## MAY

- ▶ Apopkas Emancipation Day
- ▶ Central Florida Railroad Museum Community Day - Winter Garden
- ▶ Community Clean Up Day - Maitland
- ▶ Memorial Day Celebration - Apopka & Winter Garden

## MAY (CONTD)

- ▶ Mothers Day Events - Orlando & Area Wide
- ▶ Shop, Dine & Stroll - Winter Garden
- ▶ Spring Clean up - Winter Park
- ▶ The Orlando Fringe
- ▶ Winter Park Wine & Jazz Experience

## JUNE

- ▶ Arts After Dark Market - Orlando
- ▶ Cruz-n-Car Show- #rd Saturday - Winter Garden
- ▶ Fathers Day Events - Orlando & Area Wide
- ▶ Juneteenth Celebrations - Area Wide
- ▶ Puerto Rican Day Parade & Festival - Orlando
- ▶ Top Choice Fine Arts Annual Awards Show - Winter Garden

## JULY

- ▶ 4th of July Fireworks & Celebrations - Orlando
- ▶ 4th of July Party in the Park - Winter Garden
- ▶ All American Kids Parade - Winter Garden
- ▶ Annual 4th of July Celebrations - Winter Park
- ▶ AstroFest - Orlando
- ▶ Back toSchool Bash - Orlando
- ▶ City of Apopka's 5th of July Celebrations
- ▶ City of Orland Parks & Rec City Celebration
- ▶ Christmas In July - Orlando
- ▶ Falun Dafa Event - Orlando
- ▶ Fireworks at the Fountain - Orlando
- ▶ Hot Freaks - Orlando
- ▶ Ice Cream Social - Winter Park
- ▶ Moofest Weekend - Orlando
- ▶ Orlando BalVinar Kid\$ Bi\$ Childrens
- ▶ Business Fair - Orlando
- ▶ Party in the Park & Fireworks - Winter Garden
- ▶ Tacos & Tequila Event - Orlando
- ▶ Viva Peru Fest - Orlando

## AUGUST

- ▶ Back to School Bash - Winter Garden
- ▶ BLK Joy Festival - Orlando
- ▶ DT Sidewalk Sales - Winter Garden
- ▶ International Food on Wheels Festival - Orlando
- ▶ Lake Nona Triathlon - Orlando
- ▶ Magical Dining Month - Orlando
- ▶ Monster Jam - Orlando
- ▶ Orlando Philharmonic Strings Serenade
- ▶ SWERV Block Party & Car Show - Orlando

## SEPTEMBER

- ▶ 911 Memorial Ceremony - Orlando
- ▶ Annual Labor Day 5K
- ▶ Blue Bamboo Jazz Festival - Winter Park
- ▶ Cruz-n-Car Show - Winter Garden
- ▶ Fall Community Expo - Maitland
- ▶ Halloween Horror Nights - Thru October - Orlando
- ▶ Hispanic Heritage Celebrations - Orlando
- ▶ Howl-O-Scream - Thru October - Orlando
- ▶ Lake Clean up Days - Orlando
- ▶ NatureFest at Oakland Nature Preserve - Winter Garden
- ▶ PCOS Awareness 5K Run - Orlando
- ▶ Sparkle & Shine 5K - Winter Park
- ▶ Sustainability & EV Car Show - Orlando

## OCTOBER

- ▶ Blossom Girl Community Clean Up - Orlando
- ▶ Crooked Can - Oktoberfest - Winter Garden
- ▶ Downtown Merchants host Trick or Treat Event - Winter Garden
- ▶ Fall Family Festival - Apopka
- ▶ Get Hooked Family Fishing Event - Winter Park
- ▶ Halloween Fest - Winter Garden
- ▶ Halloween in the Park - Apopka

## OCTOBER (CONTD)

- ▶ Halloween Spooktacular - Orlando
- ▶ Halloween Trunk Fest - Winter Park
- ▶ National Night Out Community Event - Winter Garden
- ▶ Saturday Sounds - Free Concerts - Thru May - Apopka
- ▶ Winter Garden Halloween Experience
- ▶ Winter Park Autumn Art Festival
- ▶ Winter Park Pumpkin Party
- ▶ Winter Park Rummage Sales
- ▶ Winter Park Trick or Treating
- ▶ ZORA Festival - Orlando

## NOVEMBER

- ▶ Apopka Tree Lighting
- ▶ Challenge 22 Annual Ruck Walk - Winter Garden
- ▶ City of Winter Garden Craft Affair
- ▶ Donut Dash 5k Walk/Run - Winter Garden
- ▶ Fall Clean Up - Winter Park
- ▶ FusionFest - Orlando
- ▶ Health & Harvest Festival - Winter Garden
- ▶ Jingle Eve - Orlando
- ▶ Maitland Rotary Festival
- ▶ Small Business Saturday - Area Wide
- ▶ Thanksgiving Events - Area Wide
- ▶ Veterans Day Ceremonies - Apopka & Winter Park
- ▶ Veterans Day Parade - Orlando

## DECEMBER

- ▶ A Merry Winter Garden Light Show
- ▶ Annual Winter Garden Christmas Golf Cart Parade
- ▶ Annual Winter Park Christmas Parade & Tree Lighting
- ▶ Apopka Christmas Parade
- ▶ Chanukah Celebrations & Menorah Lighting - Winter Garden
- ▶ Chanukah on the Park - Winter Park
- ▶ Christmas Eve Celebration - Winter Park
- ▶ Christmas Parade - Winter Garden
- ▶ Helping Others Holiday Open House - Winter Park
- ▶ Holiday POPS Free Concert - Apopka
- ▶ Horse Drawn Carriage Tours - Winter Gaden
- ▶ Light Up Hannibal Square - Winter Park
- ▶ Light Up Winter Garden
- ▶ Merry Tuba Christmas - Winter Park
- ▶ NYE Party - Orlando & Winter Park
- ▶ Rotary Club of Winter Park Holiday Boat Parade
- ▶ Santa Shift Open House - Winter Park

*\* Events are subject to change*

Administrative Services.....	407-836-7396
Airport.....	407-825-2001
Animal Services.....	407-836-3111
Board of County Commissioners.....	407-836-7350
Carrer Source Central FL.....	800-757-4598
Child Support.....	407-836-2059
Clerk of Courts.....	407-836-2000
Communications.....	407-836-7370
Community & Family Services.....	407-836-7658
Comptroller	Records.....407-836-5115
	Administration.....407-836-5690
Corrections.....	407-836-3560
County Attorney.....	407-836-7320
County Mayor.....	407-836-7370
Economic Trade & Tourism Development.....	407-836-7370
Elections Supervisor.....	407-836-2070
Emergency.....	911
Emergency Management.....	407-836-9140
Fire Rescue.....	407-836-2600
FDEP/FIDept.ofEnvironmentalProtection.....	850-245-2118
Jail / Inmate Services.....	407-836-3400
Judiciary.....	407-836-2050
Library.....	407-835-7323
License Services.....	407-434-0312
Medical Examiner.....	407-836-9400
Parks & Recreation.....	407-836-6200
Planning,Environmental & Development Services.....	407-836-5312
Public Works.....	407-836-7900
Sheriff Non Emergency.....	407-836-4357
Records.....	407-254-7280
UF/IFAS Extension.....	407-254-9200
Utilities.....	407-254-9900
Veterans Services.....	407-836-8990
Water, Garbage & Recycling.....	407-836-5515
Zoning.....	407-836-3111



In 1821, the transfer of Florida to the United States led Governor Andrew Jackson to establish two counties: Escambia, situated west of the Suwannee River, and St. Johns, located to the east. Twenty-three years later, the area south of St. Johns County was organized into Mosquito County, with Enterprise designated as its county seat. This vast county encompassed a significant portion of central Florida. When Florida gained statehood in 1845, Mosquito County was renamed Orange County, a nod to the citrus fruit that dominated the local agricultural industry. By the early 1970s, Orange County's citrus production had reached its peak, with approximately 80,000 acres dedicated to orange cultivation. The lush, dark-green foliage of orange trees and the sweet fragrance of blooming orange blossoms characterized the county's landscape. As of the 2020 census, Orange County, situated in Central Florida, boasts a population of 1,429,908, with Orlando serving as its county seat.

<b>Cities</b>	<b>Census-Designated Places</b>	Lake Hart - 1,052	Union Park - 10,452
Apopka - 54,873	Alfaya - 92,452	Lake Mary Jane - 1,790	University - 31,084
Bay Lake - 29	Azalea Park - 12,556	Lockhart - 14,058	Wedgfield - 8,017
Belle Isle - 7,032	Bay Hill - 4,884	Meadow Woods - 43,790	Williamsburg - 7,908
Edgewood - 2,685	Bithlo - 8,268	Oak Ridge - 25,062	Zellwood - 2,758
Lake Buena Vista - 24	Christmas - 2,439	Orio Vista - 6,806	
Maitland - 19,543	Clarcona - 2,990	Paradise Heights - 1,260	
Ocoee - 47,295	Conway - 13,467	Pine Castle - 11,122	
Orlando - County Seat - 2,509,831	Dr. Phillips - 12,328	Pine Hills - 66,111	
Winter Garden - 46,964	Four Corners - 56,381	Rio Pinar - 5,409	
Winter Park - 29,795	Fairview Shores - 10,239	Sky Lake - 7,226	
	Golden Rod - 12,039	South Apopka - 6,803	
<b>Towns</b>	Gotha - 2,217	Southchase - 16,276	
Eatonville - 2,349	Holden Heights - 3,679	Taft - 2,221	
Oakland - 3,516	Horizon West - 58,101	Tangelo Park - 2,459	
Windermere - 3,030	Hunter's Creek - 14,321	Tangerine - 3,237	
	Lake Butler - 18,851	Tildenville - 475	

*\*Populations are approximate.*

## Alafaya

Tucked away in the heart of Orange County, Florida, lies the charming community of Alafaya, a place steeped in history and rich in natural beauty. Founded in the early 19th century, the area was initially inhabited by the Seminole Native American tribe, who were drawn to the region's abundant wildlife and fertile soil. The name "Alafaya" is derived from the Creek word "Alafia," meaning "river of the sink," which refers to the nearby Alafia River, a winding waterway that played a vital role in the region's early development. Today, Alafaya is a thriving suburban community, boasting a population of 92,452.

## Apopka

Apopka, Florida, a city nestled in the heart of Orange County, boasts a rich history dating back to the early 19th century. Founded in 1857, the area was initially inhabited by the Seminole Indians, who were drawn to the region's lush natural surroundings and abundant wildlife. The city's name, "Apopka," is derived from the Seminole word "Ahapopka," meaning "potato-eating place," a nod to the staple crop of the indigenous people. As the city grew, so did its population, which was largely comprised of settlers from the North and freed slaves from the South. Today, Apopka has a population of 54,873.

## Ocoee

In the 1850s, a malaria outbreak prompted Dr. J.D. Starke to relocate a group of afflicted slaves to a pristine lake surrounded by open pine woods, where they could access clean water and mitigate the spread of the disease. The makeshift camp they built on the lake's north side served as a daily commute hub for working the nearby Lake Apopka fields and a safe haven for rest at night. As the camp evolved into a thriving village, it adopted the name Starke Lake, that still identifies the lake today. Following the American Civil War, the village experienced significant growth as Confederate veterans and their families settled in the area, including Captain Bluford Sims and General William Temple Withers, who wintered there. On October 5, 1883, Captain Sims received a 74-acre land grant west of Starke Lake, now part of downtown Ocoee. Two years later, Captain Sims and the original settlers successfully petitioned to have the town formally platted and renamed Ocoee, inspired by the Tennessee river of his childhood. The name Ocoee, derived from the Cherokee word "uwagahi" meaning "apricot vine place," also influenced the city's choice of flower. As of the 2020 US Census, Ocoee's population has grown to 47,295.

- Other Unincorporated Communities**
- Andover Lakes
  - Chinatown
  - Fairvilla
  - Killarney
  - Plymouth
  - Reedy Creek Improvement District
  - Vineland

## Orlando

In central Florida, a region that would eventually become Orlando, a Seminole reservation was established in 1823 through the Treaty of Moultrie Creek. However, the Indian Removal Act of 1830 led to the forced relocation of the Seminole to Oklahoma, sparking the Second Seminole War. In response, the Armed Occupation Act of 1842 encouraged white settlers to move into the area. The first of these settlers, Aaron Jernigan from Georgia, arrived in 1843 and settled near Lake Holden. The following year, Mosquito County was renamed Orange County, with its county seat later relocated to Mellonville, near Sanford. As the interior of the county began to attract settlers by 1856, the need for a more central courthouse became apparent. In 1857, the town of Orlando was founded, featuring a courthouse square surrounded by four streets. The young town struggled during the Union blockade, but the Reconstruction Era brought rapid growth, leading to Orlando's incorporation in 1875 with a population of 85 residents. The town briefly revoked its charter in 1879 but was reincorporated soon after. Orlando officially became a city in 1885. During the period between the Spanish-American War and World War I, Orlando developed into a popular resort destination. The 1920s saw a surge in housing development, fueled by the Florida Land Boom, which caused land prices to skyrocket. Dozens of neighborhoods were built near downtown during this time. However, the boom came to an end with the devastating hurricanes of the late 1920s and the onset of the Great Depression. Today, Orlando is a thriving city and the county seat of Orange County, Florida, with a population of 2,509,831, according to the U.S. Census Bureau.

## Winter Garden

In 1880, the construction of a South Florida Railroad track between Orlando and Sanford sparked development in the area, with the rail line passing just west of Osceola. Around the same time, Loring Chase, seeking to recover from a lung disease, relocated to Orange County from Chicago. During his travels, he stumbled upon a picturesque cluster of lakes east of the railbed, which caught his attention. Teaming up with Oliver E. Chapman, a wealthy investor from New England, they acquired a substantial tract of land for \$13,000 on July 4, 1881. Their vision was to create the town of Winter Park, which they carefully planned and designed over the next four years. The town's infrastructure took shape, with streets, a town hall, and a store being built, as well as the planting of orange trees. To maintain a cohesive aesthetic, they established strict architectural and stylistic guidelines for all buildings. The result was a meticulously planned city, evident in its grid-like street pattern. To attract residents, the founders aggressively marketed Winter Park to northerners seeking a warm winter retreat. During this period, the Winter Park Post Office was established, and the railroad built a depot, accessible from Osceola via a dirt road. As of the 2020 census, the population of Winter Park had grown to 29,795.

## Health Benefits of the Outdoors



**Spending time in nature offers numerous benefits for physical, mental, and emotional well-being.**

**Stress Reduction:** Nature has a calming effect on the mind and body, helping to reduce stress levels. The peaceful surroundings, fresh air, and natural beauty can lower cortisol levels, decrease heart rate, and promote relaxation.

**Improved Mental Health:** Being in nature is associated with improved mood and mental health. Studies have shown that spending time outdoors can reduce symptoms of anxiety, depression, and other mental health disorders. Nature provides a sense of tranquility and perspective, which can help alleviate negative thoughts and emotions.

**Increased Physical Activity:** Nature encourages physical activity, whether it's hiking, biking, walking, or simply exploring outdoor spaces. Engaging in outdoor activities promotes exercise, which is essential for maintaining physical health and fitness. Additionally, being in nature often involves exposure to sunlight, which helps the body produce vitamin D and supports overall well-being.

**Enhanced Creativity & Cognitive Function:** Nature stimulates creativity and cognitive function. Research suggests that spending time in natural environments can improve problem-solving skills, boost creativity, and enhance concentration and focus. Nature provides a rich sensory experience that activates different parts of the brain, fostering cognitive development and innovation.

**Connection with the Environment:** Spending time in nature fosters a deeper connection with the environment and promotes environmental stewardship. When people experience the beauty and wonder of nature firsthand, they are more likely to develop a sense of appreciation and respect for the natural world. This connection can lead to greater awareness of environmental issues and a desire to protect and preserve natural habitats for future generations.

**Overall, being in nature offers a multitude of benefits for both physical and mental well-being, making it essential for maintaining a healthy and balanced lifestyle.**

# AREA TRAILS

**Orange County might be known for its theme parks, but there are some great hiking spots where you can enjoy nature and get away from the hustle and bustle. Here are some of the best hiking areas in the area:**

#### **WEKIWA SPRINGS STATE PARK:**

Offers a range of trails through lush forests and along the Wekiwa River. Popular trails include the Red Trail and the Black Trail, both of which provide scenic views and opportunities to see local wildlife. The park is also known for its clear springs and opportunities for swimming and canoeing.

#### **TIBET-BUTLER NATURE PRESERVE:**

This 440-acre preserve has a network of trails that meander through hardwood swamps, pine flatwoods, and upland hardwood forests. The Pine Forest Trail and Swamp Trail offer good opportunities for birdwatching and enjoying a variety of Florida ecosystems.

#### **LAKE LOUISA STATE PARK:**

The park offers several trails including the Hickory Ridge Trail, which provides scenic views of Lake Louisa and the surrounding landscape. The park is also known for its diverse wildlife and beautiful lake views.

#### **LITTLE BIG ECON STATE FOREST:**

This forest features trails like the Econ River Trail, which runs alongside the Econlockhatchee River and offers opportunities for wildlife viewing and scenic river views. The trails vary in difficulty, providing options for both casual walkers and more serious hikers.

#### **SEMINOLE-WEKIVA TRAIL:**

A multi-use trail that's great for hiking, biking, and jogging. It runs through a variety of landscapes, including woods and wetlands, and provides access to several smaller trails and parks along the way.

#### **HONTOON ISLAND STATE PARK:**

Offers trails through natural Florida landscapes, including the Hontoon Island Trail. You'll find a mix of hardwood swamps and upland forests. The island is also known for its tranquility and wildlife.

#### **BLACK BEAR WILDERNESS AREA:**

The Black Bear Trail is a 7.1-mile loop that takes you through a variety of habitats including swamps and upland hardwood forests. It's known for its wildlife, including black bears, deer, and a variety of bird species.

#### **JOHN CHESTNUT SR. PARK:**

This park features the Birding Trail and West Loop Trail, which wind through various natural areas including swamps and pinelands. The park is also popular for its scenic views of Lake Tarpon.

***These trails and parks offer a great way to experience the natural beauty of Central Florida and enjoy a day of hiking and outdoor activity.***



FALLEN SPARROW  
TATTOO COMPANY

## TATTOO | PIERCING | REMOVAL

Fallen Sparrow Tattoo Co. was established in 2009 in Kissimmee, FL. Since then, we have gone on to win numerous awards and international recognition.

But that's not what's important to us; what matters is being able to use our services and our platform to help our community. We are grateful for every single incredible story that walks through our doors. Go to our website to find the artist who'll bring your vision to life.

TATTOOS, THEY'RE FOREVER.



**Email**  
fallensparrowtattoos@gmail.com  
**Phone**  
407•507•4966  
**Website**  
fallensparrowtattoos.com

Bring this flyer in for 10% off



## COUNTY PARKS

### Arcadia Acres Park

7768 Lady Frances WY | Orlando |  
(407) 254-9030

### Barber Park

3701 Gatlin Ave. | Orlando | (407) 254-6860

### Barnett Park/Barnett Gym

4801 W Colonial Dr. | Orlando | (407) 836-6248

### Beeman Park

2301 Lake Sue Dr. | Orlando | (407) 836-6200

### Bentonshire Park

7327 Bentonshire Ave. | Windermere |  
(407) 836-6200

### Big Oak Park

531 Kenmore Cr. | Orlando | (407) 836-6200

### Blanchard Park

2451 N Dean Rd. | Union Park | (407) 254-9030

### Bomberos Field Park

11485 Moss Park Rd. | Orlando | (407) 254-6840

### Capehart Park

715 Capehart Dr. | Orlando | (407) 254-9160

### Cheney Heights Park

9305 Mavis St. | Orlando | (407) 254-9180

### Clarcona Horse Park / Clarcona Outpost

3535 Damon Rd. | Apopka | (407) 254-9010

### Corporal Patrick Deans Park

16351 Timber Springs Blvd. | Orlando |  
(407) 254-9180

### Crystal Lake Park

1731 E Crystal Lake Ave. | Orlando |  
(407) 836-6200

### Cypress Grove Park

290 Holden Ave. | Orlando | (407) 254-6770

### Donnybrook Park

9109 Donnybrook Dr. | Orlando | (407) 254-9180

### Downey Park

10107 Flowers Ave. | Orlando | (407) 254-9180

### Eagles Roost

10525 Clapp Simms Duda Rd. | Orlando |  
(407) 836-1400

### East Orange District Park

22023 E Colonial Dr. | Christmas |  
(407) 254-6830

### East Orange Neighborhood Park

12080 E Colonial Dr. | Orlando | (407) 254-9180

### East Tangerine Park

6061 Terrell Rd. | Mt. Dora | (407) 254-1982

### Fort Christmas Historical Park

1300 Fort Christmas Rd. | Christmas |  
(407) 254-9310

### George Bailey Park

11974 Roberson Rd. | Winter Garden |  
(407) 254-9086

### Gotha Park

10013 Park Ridge Gotha Rd. | Windermere |  
(407) 836-6200

### Honolulu Park - 8200 Honolulu Dr. | Orlando |

(407) 836-6200

### Horizon West Regional Park

Hamlin Groves Trail at Mann Rd. | Winter Garden  
| (407) 254-1940

### Hourglass Park

1800 Carlton Dr. | Orlando | (407) 836-6200

### Independence Park

5849 New Independence Pkwy. | Winter Garden  
| (407) 254-1940

### Interlaken Park

93 Interlaken Rd. | Orlando | (407) 836-6200

### Ivey Lane Park

291 Silverton St. | Orlando | (407) 246-4457

### Kaley Square Park

2106 S Westmoreland Dr. | Orlando |  
(407) 836-6200

### Kelly Park/Rock Springs

400 E Kelly Park Rd. | Apopka | (407) 254-1902

### Lake Lawne Park

1320 Lawne Blvd. | Orlando | (407) 836-6248

### Lake Pearl Park

1700 Twin Lake Dr. | Gotha | (407) 836-6200

### Lakeside Village Park

10820 Village Lake Rd. | Windermere |  
(407) 254-1940

### Lester Mandell Park

3500 Central FL Pkwy. | Orlando |  
(407) 254-1920

### Little Econ Greenway

2451 N Dean Rd. | Orlando | (407) 254-9030

### Long Branch

710 S County Rd. 13 | Orlando | (407) 836-1400

### Magnolia Park

2929 S Binion Rd. | Apopka | (407) 254-9046

### Millennium Park

5101 Santa Rosa Dr. | Orlando | (407) 254-9325

### Moss Park

12901 Moss Park Rd. | Orlando | (407) 254-6840

### Orlo Vista Park

1 N Powers Dr. | Orlando | (407) 254-9050

### Padgett Park

5811 Padgett Cr. | Santa Rosa | (407) 836-6200

### Park Manor Neighborhood Park

1533 Park Manor Dr. | Orlando | (407) 254-9180

### R. D. Keene Park

10900 Chase Rd. | Windermere | (407) 254-1940

### Riverside Acres

8636 Garnet Ave. | Orlando | (407) 836-6200

### Rolling Hills Park

4950 N Pine Hills Rd. | Orlando | (407) 254-9250

### Roosevelt Martin Park

210 Bayshore Dr. | Orlando | (407) 836-6200

### Roosevelt Nichols Park

1601 Hermit Smith Rd. | Apopka |  
(407) 254-9046

### Rose Place Park

8200 Old Winter Garden Rd. | Orlando |  
(407) 254-9050

### South Lake Mann Park

4302 Raleigh St. | Orlando | (407) 836-6200

### Summerlake Park

15570 Porter Rd. | Winter Garden |  
(407) 836-6200

### Summerport Neighborhood Park

14491 Bridgewater Crossings Blvd. |  
Windermere | (407) 254-9086

### Taborfield Park

9025 Taborfield Rd. | Orlando | (407) 254-1940

### Taft Ball Field

1140 5th Ave. | Orlando | (407) 254-1920

### Taft Neighborhood Park

124 Cypress St. | Orlando | (407) 836-6200

### Tildenville Park

202 Shongi Ave. | Winter Garden |  
(407) 254-9245

### Tom Staley Historical Park

211 E Third St. | Apopka | (407) 533-4732

### Trimble Park

5802 Trimble Park Rd. | Mt. Dora |  
(407) 254-1982

### Vogt-Meloon Park

814 W Oak Ridge Rd. | Orlando | (407) 836-6200

### Warren Park

3406 Warren Park Rd. | Orlando |  
(407) 254-6860

### Watermark Park

Seidel Road at Summerlake Grove St. |  
Winter Garden | (407) 836-6200

### Wedgfield Park

20425 Mansfield St. | Orlando | (407) 254-1905

### West Beach Park

9227 Winter Garden Vineland Rd. | Orlando |  
(407) 254-1940

## **West Orange Park**

150 Windermere Rd. | Winter Garden |  
(407) 254-9086

## **West Tangerine Park**

7101 Wright Ave. | Mt. Dora | (407) 254-1982

## **Winter Park Estates Park**

2724 Aloma Ave. | Winter Park | (407) 836-6200

## **Yucatan Park**

6400 Yucatan Dr. | Orlando | (407) 254-9160

## **TRAILHEADS**

### **Avalon Mailer Trailhead**

14001 Mailer Blvd. | Orland | (407) 254-9180

### **Avalon Trail**

14001 Mailer Blvd. | Orlando | (407) 836-6200

### **Baldwin Park Trailhead / 436 Pedestrian-Bike Bridge**

2221 Truman Rd. | Orlando | (407) 836-6200

### **Cady Way Trail**

821 Herndon Ave. | Orlando | (407) 254-9030

### **Clarcona Ocoee Connector Trail**

3535 Damon Rd. | Apopka | (407) 254-9010

### **Lake Apopka Loop Trail**

2929 S Binion Rd. | Apopka | (407) 254-9046

### **Neighborhood Lakes West Trailhead**

6701 Mt. Plymouth Rd. | Apopka |  
(407) 254-1902

### **West Orange Trail**

501 Crown Point Cross Rd. | Winter Garden |  
(407) 533-4732

### **West Orange Trail**

Apopka Station -111 S Forest Ave. | Apopka |  
(407) 533-4732

### **West Orange Trail**

Apopka-Vineland Outpost -5794 N Apopka  
Vineland Rd. | Orlando | (407) 533-4732

### **West Orange Trail**

Chapin Station -501 Crown Point Cross Rd. |  
Winter Garden | (407) 533-4732

## **West Orange Trail**

Killarney Station -17914 State Road 438 |  
Winter Garden | (407) 533-4732

## **West Orange Trail**

Winter Garden Station -455 E Plant St. |  
Winter Garden | (407) 533-4732

## **COMMUNITY PARKS**

### **Bithlo Community Park**

18501 Washington Ave. | Orlando |  
(407) 254-1905

### **Deputy Brandon Coates Community Park**

3815 Substation Rd. | Orlando | (407) 254-1920

### **Deputy Scott Pine Community Park**

6865 Ficquette Rd. | Windermere |  
(407) 254-9086

### **Dr. P. Phillips Community Park**

8249 Buenavista Woods Blvd. | Orlando |  
(407) 254-9038

### **Lake Ellenor Community Park**

7300 Lake Ellenor Dr. | Orlando | (407) 254-1920

### **Renaissance Senior Center/South Econ Community Park**

3800 S Econlockhatchee Trl. | Orlando |  
(407) 254-9070

### **Tangelo Community Park**

5160 Pueblo St. | Orlando | (407) 254-9175

### **Young Pine Community Park**

5201 Young Pine Rd. | Orlando | (407) 254-1900

## **RECREATION PARKS & SPORTS COMPLEX**

### **Bear Creek Recreation Complex**

1600 Bear Crossing Dr. | Orlando |  
(407) 254-9040

### **Dr. Phillips Ballfield Complex**

10496 Bissell St. | Orlando | (407) 254-9038

### **Econ Soccer Complex**

8035 Yates Rd. | Orlando | (407) 254-9030

## **Ft. Gatlin Recreation Complex**

2009 Lake Margaret Dr. | Orlando |  
(407) 254-9820

## **Goldenrod Recreation Center/Goldenrod Park**

4863 N Goldenrod Rd. | Winter Park |  
(407) 254-9025

## **Marks Street Senior Recreation Complex**

99 E Marks St. | Orlando | (407) 254-1066

## **Meadow Woods Recreation Center/ Meadow Woods Park**

1751 Rhode Island Woods Circle | Orlando |  
(407) 254-9065

## **Shadow Bay Park/Lake Cane Tennis Center**

5100 Turkey Lake Rd. | Orlando | (407) 254-9175

## **Silver Star Recreation Center/Silver Star Community Park**

2801 N Apopka-Vineland Rd. | Orlando |  
(407) 254-9250

## **South Econ Recreation Center/South Econ Community Park**

3850 S Econlockhatchee Trl. | Orlando |  
(407) 254-9092

## **South Orange Youth Sports Complex**

11800 S Orange Ave. | Orlando | (407) 254-1920

## **West Orange Recreation Center**

309 S West Crown Point Rd. | Winter Garden |  
(407) 254-9245

## **PARK PRESERVE, RESERVE, FORESTS & CONSERVATION AREAS**

### **Charles H. Bronson State Forest**

3563 Phillips Rd. | Christmas | (407) 971-3500

### **Crosby Island Marsh Preserve**

13601 Moss Park Rd. | Orlando | (407) 836-1400

### **Econlockhatchee Sandhills Conservation Area**

15227 Lake Pickett Rd. | Orlando |  
(407) 836-1400

### **Hal Scott Regional Preserve and Park**

5150 Dallas Blvd. | Orlando | (386) 329-4404

### **Hidden Pond Preserve**

20501 FL-520 | Orlando | (407) 836-1400

### **Isle of Pine Preserve**

14032 Lacebark Pine Rd. | Orlando |  
(407) 836-1400

### **Johns Lake Conservation Area**

880 Avalon Rd. | Winter Garden |  
(407) 836-1400

### **Lake Lucie Conservation Area**

43 Rainey Rd. | Sorrento | (407) 836-1400

### **Pine Lily Preserve**

1401 S County Rd. 13 | Orlando | (407) 836-1400

### **Sandhill Preserve**

5611 Plymouth Sorrento Rd. | Apopka |  
(407) 836-1400

### **Savage Christmas Creek Preserve**

11046 NW Christmas Rd. | Christmas |  
(407) 836-1400

### **Split Oak Forest**

12901 Moss Park Rd. | Orlando | (407) 254-6840

### **Tibet-Butler Preserve**

8777 Winter Garden - Vineland Rd. | Orlando |  
(407) 254-1940

# VETERAN OWNED & OPERATED

Lic #RF11067589

## National Plumbing

*The People's Plumber*

LICENSED & INSURED

### RESIDENTIAL & COMMERCIAL SERVICES



## THE PEOPLE'S PLUMBER

It is our pledge, our promise to all customers, that we will provide each and every customer with our award winning quality service. A tradition spanning over 50 years passed down from father to son. Honesty, Integrity, and a true passion for plumbing while, protecting the health & safety of our nation. - H. Helton (Master Plumber & President)

**VETERAN DISCOUNTS! CALL TODAY!**

# 1-407-300-7690

[ThePeoplesPlumber@nationalplumbingFL.com](mailto:ThePeoplesPlumber@nationalplumbingFL.com)

*florida plaza liquor #2*

1704 North Main Street, Kissimmee, FL 34744 • (407) 978-6088

**We Are Available On The APP Store  
Download the APP Today!**

**LIQUOR**  
BEER & TOBACCO OUTLET

**WE DELIVER**

**STORE HOURS**

Mon - Wed 9AM - 10PM	Thu - Sat 9AM - 11PM	Sundays 9AM - 10PM
-------------------------	-------------------------	-----------------------

Uber Eats, DOORDASH, Great Check, Lite, Heinek

J&B, Jameson, Tito's, Aperol, SKYY, Amigon, SVEDKA, Heinek

Enter the World of RVing!



THE ONLY RV DEALER TO OFFER

**LIFETIME WARRANTY**

**CENTRAL & NORTH FLORIDA'S ONLY**  
RV LIFETIME WARRANTY DEALER

**CALL NOW!**



**GIANT SPECIALTY VEHICLES** GOLF CART SALES, RENTAL & SERVICE!

SALES  
SERVICES  
PARTS &  
ACCESSORIES  
ADVANCED

2024 FOREST RIVER IMPRESSION

Visit Us Online



**2024 COACHMEN CLIPPER 17CBH CADET**

LIST PRICE \$24,091

**DISCOUNT \$8,094**

**NOW: \$15,997**

WEEKLY PAYMENT OF \$37



**2024 KEYSTONE BULLET CROSSFIRE 2220ML**

LIST PRICE \$41,329

**DISCOUNT \$7,830**

**NOW: \$31,499**

WEEKLY PAYMENT OF \$68



**2024 FOREST RIVER CARDINAL 23RK**

LIST PRICE \$66,167

**DISCOUNT \$28,723**

**NOW: \$37,444**

WEEKLY PAYMENT OF \$90



**ALL NEW 2024 COACHMEN NOVA 20C**

LIST PRICE \$188,526

**DISCOUNT: \$61,527**

**NOW: \$126,999**

WEEKLY PAYMENT \$263



GROSS VEHICLE WEIGHT RATIO 9,350 LB.



POWER RETRACTABLE 13.1 FT. AWNING



EXCLUSIVE PROMASTER® 3500 CHASSIS

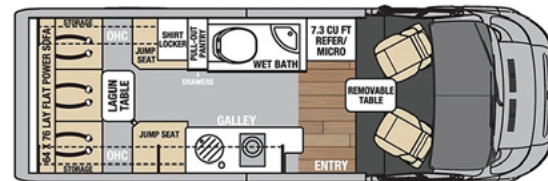

SCAN TO SEE ONLINE



VISIT OUR AIR-CONDITIONED SHOWROOMS TODAY!

[www.GiantRecreationWorld.com](http://www.GiantRecreationWorld.com)

**WINTER GARDEN**  
13906 W. Colonial Dr.  
Winter Garden, FL 34787  
(407) 573-1305

**DESTINATION DAYTONA**  
280 Destination Daytona Ln.  
Ormond Beach, FL 32174  
(386) 239-1110

**PALM BAY**  
1355 Culver Dr NE #1178  
Palm Bay, FL 32907  
(321) 541-2205

You can purchase hunting and fishing licenses online <https://myfwc.com>, or call Fishing 888-347-4356, Hunting 888-486-8356 or visit one of the FWC agents available throughout the area:

## BASS PRO SHOPS OUTDOOR WORLD

5156 International Dr. | Orlando | (407) 563-5200

## DICKS SPORTING GOODS #631

1100 N Alafaya Trl. Shoppes At Alafala | Orlando | (407) 380-9066

## DICKS SPORTING GOODS #1179

724 Herndon Ave. | Orlando | (321) 332-9991

## ORANGE TC - E ORANGE

10051 University Blvd. | Orlando | (407) 434-0312

## ORANGE TC - S ORLANDO

730 Sand Lake Rd. | Orlando | (407) 434-0312

## ORANGE TC - S ROSALIND

301 S Rosalind Ave. | Orlando | (407) 434-0312

## ORANGE TC - W COLONIAL

9401 W Colonial Dr. | Ocoee | (407) 434-0312

## ORANGE TC - WINTER PARK

4101 Clarcona Ocoee Rd. | Orlando | (407) 434-0312

## WEST MARINE #1098

7478 S. Orange Blossom Trl. | Suite A | Orlando | (407) 857-7337

## WEST MARINE #1256

670 Lee Rd. | Orlando | (407) 644-8557

## WAL MART #110

16313 New Independence Parkway | Winter Garden | (407) 554-0182

## WALMART #890

11250 E Colonial Dr. | Orlando | (407) 281-8941

## WALMART #908

8101 South John Young Pkwy. | Orlando | (407) 354-5665

## WALMART #942

10500 W Colonial Dr. | Ocoee | (407) 877-6900

## WALMART #955

1700 S Orange Blossom Tr. | Apopka | (407) 889-8668

## WALMART #1220

2500 S Kirkman Rd. | Orlando | (407) 290-6977

## WALMART #1084

3838 S Semaron Blvd. | Orlando | (407) 277-4314

## WALMART #3782

5991 New Goldenrod Rd. | Orlando | (407) 382-8880

## WALMART #4332

8990 Turkey Lake Rd. | Orlando | (407) 351-2229

## WALMART #4365

11930 Narcoossee Rd. | Orlando | (407) 204-2039

## WALMART #4588

3101 West Princeton St. | Orlando | (321) 354-2096

## WALMART #5871

5734 S Orange Blossom Trail | Orlando | (321) 247-4817

# Top Freshwater Fishing Locations

Florida is renowned for its abundance of freshwater fishing opportunities, with numerous lakes, rivers, and streams teeming with a wide variety of fish species. Here are some of the top freshwater fishing locations in Florida:

**1. Lake Okeechobee:** The largest freshwater lake in the state. Anglers can target largemouth bass, crappie, bluegill, & catfish.

**2. St. Johns River:** One of the few major rivers in the United States that flows north. It's a prime location for bass fishing, particularly in the upper stretches.

**3. Lake Tohopekaliga (Lake Toho):** The lake is famous for its trophy-sized largemouth bass. It's a popular destination for bass anglers seeking the thrill of catching big fish.

**4. The Kissimmee Chain of Lakes:** Comprising several interconnected lakes, the Kissimmee Chain offers diverse fishing experiences. Anglers can target bass, crappie, bluegill, and more in these interconnected waters.

**5. The Harris Chain of Lakes:** Consists of several lakes interconnected by canals. It's known for its bass fishing, with Lake Harris being one of the most popular spots for anglers.

**6. Rodman Reservoir:** Created by the damming of the Ocklawaha River, Rodman Reservoir is known for its trophy bass fishing. Anglers come here seeking the chance to catch monster-sized bass in a picturesque setting.

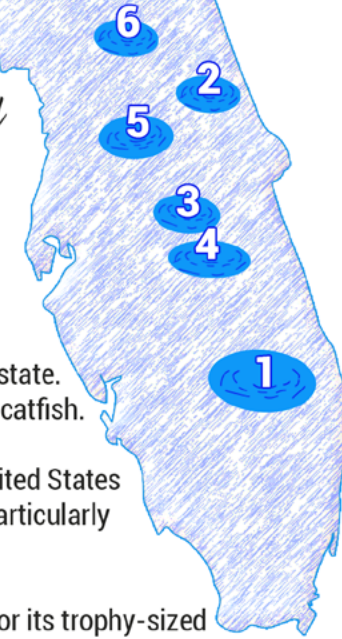



**NO SHORTCUTS.**  
We are detailed  
in our  
installation  
process.

**Your Trusted  
HVAC Experts.**

*Top-notch services  
tailored to your  
comfort needs.*

**407-753-7424**

paul.whitehead@taylorairheat.com



**Electrical Services  
Lighting Maintenance  
Lighting Installation  
Handyman Services**

**Taylor's  
Services  
Electrical  
Handyman**



**Master Electrician's  
Handymen Services**

**Emergency Services 24/7  
Free Estimates**

**Call 689-280-0614**

License & Insured

[www.myakkaelephantranch.org](http://www.myakkaelephantranch.org)



**Our Mission**

From Tusk to Tail, African to Asian, elephant conservation characterizes our primary purpose.



Intimate elephant encounters guided by professional caregivers that will enlighten, educate, and provide for an unforgettable experience.

Knowledge and understanding are the gateway to global conservation and restoration of these majestic mammals.



Our passion, dedication, & collective efforts from the public ensure the continued success in this vitally important endeavor.

**941-702-0220**



[www.myakkaelephantranch.org](http://www.myakkaelephantranch.org)

*Myakka Elephant Ranch is a non profit conservation education center focused on global elephant conservation. The nonprofit was founded in 2019 by Lou Barreda after he returned from Africa and saw the need for conservation of the species. All donations aid in supporting the elephants on the ranch as well as conservation projects all over the world.*

*As a conservation center, we believe that education combined with personal experience is the key to finding and creating lasting efforts to preserve these beloved threatened species. Through understanding, and the sharing of knowledge and information we believe that we can make a big difference!*



**941-702-0220**



# BUTTERED-UP Steak



Simple meal with a Gourmet Feel

## INGREDIENTS

2 steaks (ribeye or sirloin are good choices)

Salt and pepper

2 tablespoons unsalted butter

2 cloves garlic, minced

Fresh herbs (optional)

## INSTRUCTIONS

**1** Take the steaks out of the refrigerator and let them come to room temperature for about 30 minutes. This helps the steak cook more evenly.

**2** Preheat your oven to 400°F.

**3** Season the steaks generously with salt and pepper on both sides.

**4** Heat a large skillet over high heat until very hot. Add the steaks and cook for about 2-3 minutes per side, until nicely browned.

**5** Remove the steaks from the skillet and place them on a baking sheet.

**6** In the same skillet, add the butter and garlic. Cook for about 30 seconds, stirring constantly, until the garlic is fragrant.

**7** Pour the garlic butter over the steaks on the baking sheet.

**8** Place the baking sheet in the oven and cook for about 5-7 minutes for medium-rare doneness, or longer if you prefer your steak more well-done.

**9** Remove the steaks from the oven and let them rest for a few minutes before slicing.

**10** Serve the steak with any remaining butter from the baking sheet and fresh herbs if desired.



## BARBECUE DO'S:

- use proper barbecue equipment and tools, such as a grill, tongs, and spatulas.
- preheat your grill before placing any food on it.
- marinate your meat before cooking to enhance the flavor.
- keep a close eye on your food while grilling to prevent overcooking or burning.
- use a meat thermometer to ensure that your meat is cooked to the correct internal temperature.
- let your meat rest for a few minutes before slicing or serving to allow the juices to redistribute.
- keep your grill and utensils clean to prevent any foodborne illness.

## BARBECUE DON'TS:

- use lighter fluid to start your grill. Instead, use a chimney starter or electric starter.
- overcrowd your grill. Leave enough space between the pieces of meat to ensure even cooking.
- use a fork to flip your meat. Piercing the meat can cause it to lose its juices and become dry.
- baste your meat with sugary sauces too early in the cooking process, as it can burn and create a bitter taste.
- leave cooked meat out in the sun for too long, as it can spoil quickly.
- assume that meat is fully cooked by its color. Always use a meat thermometer to check the internal temperature.
- leave your grill unattended while it's still hot. Always make sure to properly cool it down before leaving it.



Enjoy your delicious  
buttered-up steak!

PREP: 35 MIN • TOTAL: 50 MIN



# Keep Your Pets Safe

## HERE ARE A FEW KEY POINTS TO BE AWARE OF:

- 1. Leashing:** Always keep pets on a leash, especially near water bodies, to prevent them from wandering too close to potential alligator habitats.
- 2. Supervision:** Supervise your pets when they're outside. This is crucial during dawn and dusk, as alligators are more active during these times.
- 3. Avoid Water:** Keep pets away from lakes, ponds, and marshy areas where alligators might be lurking. Even small bodies of water can pose risks.
- 4. Training:** Ensure your pets have good recall and respond well to commands. This can help you quickly call them back if they venture too close to danger.
- 5. Feeding and Food Storage:** Do not feed alligators or leave pet food outside, as this can attract wildlife and increase the likelihood of encounters with alligators.



# HURRICANE SAFETY

## Top Five Tips



### 1. STAY INFORMED

### 2. SECURE YOUR HOME

### 3. FOLLOW EVACUATION ORDERS & GUIDELINES

### 4. EMERGENCY SUPPLIES

### 5. EVACUATION PLANNING

If authorities issue evacuation orders, follow them promptly. Delaying evacuation can put your life and the lives of emergency responders at risk. They have the most up-to-date information on the storm and can provide guidance on the safest course of action. Remember that each hurricane is unique, so it's essential to stay informed and adapt your plans accordingly. Preparedness and early action are key to minimizing risks and ensuring the safety of yourself and your loved ones during a hurricane.

CAT 5  
157+MPH

## HURRICANE CATEGORIES

The Highest Recorded Wind Speed of a Hurricane is 215 mph

CAT 1-2  
74-110MPH

CAT 3-4  
110-156MPH

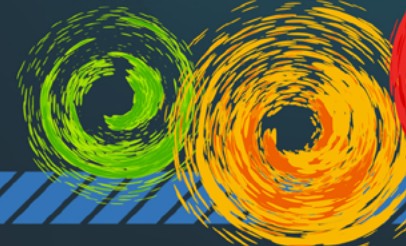

## **4 ROOTS FARM CAMPUS**

1918 W Princeton St. | Orlando |  
407-775-6424

## **ALBIN POLASEK MUSEUM & SCULPTURE GARDENS**

633 Osceola Ave. | Winet Park |  
407-647-6294

## **ANDRETTI INDOOR KARTING & GAMES**

9299 Universal Blvd. | Orlando |  
407-641-0415

## **ARCADE ORLANDO @ DEZERLAND PARK ORLANDO**

5250 International Dr. | Orlando |  
321-754-1700 / 321-978-3256

## **ART & HISTORY MUSEUMS - MAITLAND**

231 W Packwood Ave. | Maitland |  
407-539-2181

## **AQUATICA ORLANDO**

5800 Water Play Way | Orlando |  
407-545-5550

## **AUDUBON CENTER FOR BIRDS OF PREY**

1101 Audubon Way | Maitland |  
407-644-0190

## **BACH FESTIVAL SOCIETY OF WINTER PARK**

203 E. Lyman Ave. | Winter Park |  
407-646-2182

## **BEER SPA**

11787 International Dt #106 | Orlando |  
407-778-1772

## **BILL BREEZE PARK**

125 Lakeshore Dr. | Ocoee | 407-877-5803

## **CENTRAL FLORIDA COMMUNITY ARTS**

250 S Ivanhoe Blvd. W | Orlando |  
407-937-1800

## **CENTRAL FLORIDA RAILROAD MUSEUM**

101 S Boyd St. | Winter Garden |  
407-656-0559

## **CENTRAL FLORIDA VOCAL ARTS**

Winter Park | 863-510-7236

## **CENTRAL ROCK GYM ORLANDO**

1766 W Sand Lake Rd. | Orlando |  
407-601-0399

## **CHOCOLATE KINGDOM - INTERACTIVE FACTORY ADVENTURE TOUR**

9901 Hawaiian Ct. | Orlando | 407-705-3475

## **CLARCONA HORSE PARK**

3535 Damon Rd. | Apopka | 407-254-9010

## **CRAYOLA EXPERIENCE**

8001 S Orange Blossom Trl. | Orlando |  
407-757-1700

## **DRAWN TO LIFE BY CIRQUE DU SOLIEL & DISNEY**

1418 Buena Vista Dr. | Lake Buena Vista |  
877-773-6470

## **DR. PHILLIPS CENTER FOR THE PERFORMING ARTS**

4455 Magnolia Ave. | Orlando |  
844-513-2014

## **EARTH ILLUMINATED**

9101 International Dr. #2300 | Orlando |  
720-897-3855

## **ENZIAN THEATER**

1300 Orlando Ave. | Maitland |  
407-629-0054

## **ESCAPEOLOGY**

11951 International Dr. #C3 | Orlando |  
407-278-1515

## **FLORIDA THEATRICAL ASSOCIATION**

100 E Eola Sr. #200 | Orlando | 407-423-9999

## **FUN SPOT AMERICA THEME PARKS**

### **ORLANDO**

5700 Fun Spot Way | Orlando | 407-363-3867

### **GARDEN THEATER**

160 W Plant St. | Winter Garden |  
407-877-4736

### **GATORLAND - SCREAMIN' GATOR ZIP LINE**

14501 S Orange Blossom | Orlando |  
407-855-5496

### **GRAY LINE OF ORLANDO SIGHTSEEING TOURS**

7061 Grand National Dr. #139 | Orlando |  
407-522-5911

### **HARRY P LEU HAUS GARDENS**

1920 N Forest Ave. | Orlando | 407-246-2620

### **HANNIBAL SQUARE HERITAGE CENTER**

642 W New England Ave. | Winter Park |  
407-539-2680

### **HOLOCAUST MEMORIAL RESOURCE & EDUCATION CENTER OF FLORIDA**

851 N Maitland Ave. | Maitland |  
407-628-0555

### **HOOP-DE-DOO MUSICAL REVUE**

4510 N Fort Wilderness Trl. | Lake Buena Vista | 407-939-3463

### **ICON PARK**

8375 International Dr. | Orlando |  
407-601-7907

### **JUNGLE ADVENTURES INC**

26205 E Colonial Dr. | Christmas |  
407-568-2885

### **K1 SPEED ORLANDO**

5228 Vanguard St. | Orlando | 407-434-7500

## **KINGS DINING & ENTERTAINMENT**

8255 S. International Dr. #120 | Orlando |  
407-363-0200

## **KINGS LANDING**

5722 Baptist Camp Rd. | Apopka |  
407-886-0859

## **KRAFT AZALEA GARDEN**

1365 Alabama Dr. | Winter Park |  
407-599-3334

## **LAKE LILY PARK**

701 Lake Lily Dr. | Maitland | 407-875-2848

## **LEGOLAND FLORIDA RESORT / THEME PARK & PEPPA PIG THEME PARK**

1 Legoland Way | Winter Haven |  
888-690-5346

## **MAITLAND COMMUNITY PARK**

1400 Mayo Ave. | Maitland | 407-875-2848

## **MEAD BOTANICAL GARDEN**

1300 S Denning Dr. | Winter Park |  
407-622-6323

## **MINNEHAHA PARK**

1011 E Horatio Dr. | Maitland | 407-875-2848

## **MUSEUM OF THE APOPKANS**

122 E 5th St. | Apopka | 407-703-1707

## **MUSEUM OF ILLUSIONS ORLANDO - ICON PARK**

8441 International Dr. #250 | Orlando |  
833-276-9182

## **MY LITTLE TOWN KIDS**

12720 S Orange Blossom Trl. | Orlando |  
407-932-8369

## **NEHLING GARDENS**

2267 Hempel Ave. | Gotha | 407-445-9977

## **OPERA DEL SOL**

Winetr Park | 863-510-7236

# Area Attractions



## **OPERA ORLANDO**

406 E Amelia St. #100 | Orlando |  
407-512-1900

## **ORANGE COUNTY REGIONAL HISTORY CENTER**

65 E Central Blvd. | Orlando | 407-836-8500

## **ORLANDO AT PLAY.COM**

2450 Maitland Ctr. #201 | Maitland |  
407-628-0333

## **ORLANDO BALLET**

600 N Lake Formosa Dr. | Orlando |  
407-426-1733

## **ORLANDO MUSEUM OF ART**

2416 N Mills Ave. | Orlando | 407-896-4231

## **ORLANDO PHILHARMONIC ORCHESTRA**

425 N Bumby Ave. | Orlando | 407-896-6700

## **ORLANDO SCIENCE CENTER**

777 E Princeton St. | Orlando | 407-514-2000

## **ORLANDO STAR FLYER**

8265 International Dr. | Orlando |  
407-640-7009

## **RIPLEY'S BELIEVE IT OR NOT ORLANDO**

8201 International Dr. | Orlando |  
407-245-0501

## **ROLLINS MUSEUM OF ART**

1000 Holt Ave. Box#2765 | Winter Park |  
407-646-2526

## **SAK COMEDY LAB**

29 S Orange Ave. | Orlando | 407-648-0007

## **SEA WORLDS ORLANDO / AQUATICA / DISCOVERY COVE**

7007 Sea World Dr. | Orlando | 407-545-5550

## **SOBO ART GALLERY - WINTER GARDEN ART ASSOCIATION**

127 S Boyd St. | Winter Garden |  
407-347-7996

## **SYDONIE MANSION**

5538 Sydonie Dr. | Mt. Dora | 321-236-1534

## **TANK AMERICA**

6605 Muskogee St. | Orlando | 407-213-8265

## **THE BUREAU ADVENTURE GAMES**

5400 International Dr. | Orlando |  
407-904-5190

## **THE CHARLES HOSMER MORSE MUSEUM OF AMERICAN ART**

445 North Park Ave. | Winter Park |  
407-645-5311

## **THE ESCAPE GAME ORLANDO**

8145 International Dr. #511 | Orlando |  
407-501-7222

## **THE HOLOCAUST MEMORIAL RESOURCE & EDUCATIONAL CENTER OF FLORIDA**

851 N Maitland | Maitland | 407-628-0555

## **THE MAITLAND ART CENTER**

W Parkwood Ave. | Maitland

## **THE MENELLO MUSEUM OF AMERICAN ART**

900 E Princeton St. | Orlando | 407-246-4279

## **THE ORLANDO FRINGE**

812 E Rollins St. #300 | Orlando |  
407-648-0077

## **THE WIZARD OF OZ MUSEUM**

7099 N Atlantic Ave. | Cape Canaveral |  
888-949-6369

## **THE WINTER PARK PLAYHOUSE**

711 N Orange Ave. Ste# C | Winter Park |  
407-645-0145

## **TIMUCUA ARTS FOUNDATION**

2000 S Summerlin Ave. | Orlando |  
321-234-3985

## **TOPGOLF ORLANDO**

9295 Universal Blvd. | Orlando |  
407-218-7714

## **UFC ARBORETUM**

4312 Scorpius St. | Orlando

## **UNIVERSAL ORLANDO RESORT /**

## **UNIVERSAL STUDIOS / ISLANDS OF**

## **ADVENTURE/ VOLCANO BAY / THE**

## **WIZARDING WORLD OF HARRY POTTER**

## **/ UNIVERSAL CITY WALK**

6000 Universal Blvd. | Orlando |  
407-363-8000

## **USTA NATIONAL CAMPUS**

1000 USTA Blvd. | Orlando | 844-872-8667

## **WALT DISNEY WORLD RESORT / MAGIC**

## **KINGDOM / DISNEYS BLIZZARD BEACH /**

## **TYPHOON LAGOON/ EPCOT & DISNEY**

## **ANIMAL KINGDOM, HOLLYWOOD**

## **STUDIOS & DISNEY SPRINGS**

Bay Lake | 407-939-5277

## **WATERHOUSE RESIDENCE MUSEUM**

820 Lake Like Dr. | Maitland | 407-539-2181

## **WELLS BUILT MUSEUM**

511 W South St. | Orlando | 407-245-7535

## **WEST ORANGE CINEMA**

1575 Maguire Rd. | Ocoee | 407-877-3489

## **WINTER GARDEN HERITAGE MUSEUM**

21 E Plant St. | Winter Garden |  
407-656-3244

## **WINTER GARDEN VILLAGE**

3251 Daniels Rd. | Winter Garden |  
813-972-5066

## **WITHERS-MACGUIRE HOUSE**

16 E Oakland Ave. | Ocoee

## **WONDERWORKS**

9067 International Dr. | Orlando |  
407-351-8800

## **ZORA NEALE HURSTON NATIONAL**

## **MUSEUM OF FINE ARTS**

344 E Kennedy Blvd. | Eatonville |  
407-647-3304

# ADVERTISING MADE SIMPLE

Call: 727.238.8123



**LincolnMarketing**  
www.lincolnmarketing.us

# So, You have decided to get a pet... NOW WHAT??

**Commitment and Time:** Owning a pet is a long-term commitment. Before bringing a pet home, consider your lifestyle and ensure you have enough time to spend with your pet. Dogs, cats, and many other animals require attention, exercise, and mental stimulation.

**Choose the Right Pet for Your Lifestyle:** Different pets have varying needs, temperaments, and activity levels. Research and select a pet that fits well with your lifestyle, living situation, and family dynamics. Whether you choose a dog, cat, bird, fish, or any other animal, make sure you can provide for its specific needs.

**Proper Nutrition:** Feed your pet a balanced and nutritious diet suitable for their species and age. Consult with a veterinarian to determine the best food options for your pet's health and well-being.

**Regular Exercise:** Most pets need regular physical activity to stay healthy and happy. Engage in playtime and exercise with your pet daily, as it helps prevent obesity and provides mental stimulation.

**Routine Veterinary Care:** Schedule regular check-ups with a veterinarian to monitor your pet's health, get necessary vaccinations, and address any concerns. Early detection of health issues can often lead to better outcomes.

**Spaying/Neutering:** Consider spaying or neutering your pet if you don't plan on breeding. This helps control the pet population and can have health benefits for your pet.

**Training and Socialization:** Properly train your pet to follow basic commands and have good manners. Socialize them with other animals and people from a young age to prevent behavioral issues later on.

**Provide a Safe Environment:** Ensure that your home and yard are safe for your pet. Remove hazards, keep toxic substances out of reach, and provide appropriate shelter from extreme weather conditions.

**Grooming:** Regular grooming is essential for most pets. Brush their fur, trim nails, and clean their ears as needed to keep them comfortable and healthy.

**Identification and Microchipping:** Keep identification tags with your current contact information on your pet's collar. Consider microchipping your pet as an extra measure to ensure they can be identified if lost.

**Love and Attention:** Pets thrive on love and attention from their owners. Spend quality time with your pet, provide affection, and build a strong bond.

**Respect and Understanding:** Learn to understand your pet's body language and behavior. Respect their boundaries and feelings, and avoid forcing them into uncomfortable situations.

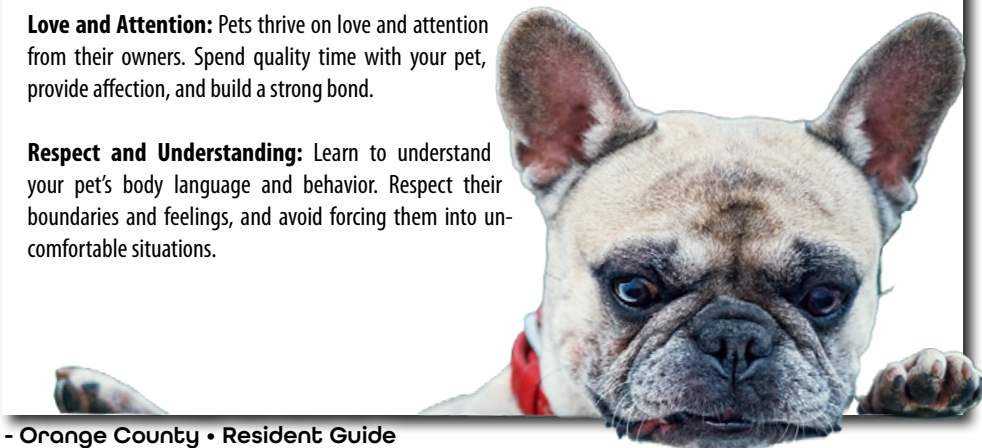

**Patience and Forgiveness:** Pets, especially young ones, can be mischievous or have accidents. Be patient with them during the training process and forgive any mistakes they make along the way.

**Emergency Preparedness:** Have a plan in place for emergencies, including natural disasters. Know how to evacuate with your pet safely if needed.

**If you have just rescued / adopted a new fur baby, please it is important to remember the 3-3-3 RULE:**  
**3 Days:**

In the first 3 days being in its new home, they will be feeling overwhelmed, scared & unsure of what is going on. They may also be uncomfortable being "themselves", and may not want to eat or drink. They may want to "shut down" or hide under a bed or in a crate, and they will test boundaries.

**3 Weeks:**

At this point, they may be a lot more comfortable & settling in. Learning a new routine can be overwhelming, so please be patient. By now they may have figured out the new environment & accepted that this may be their FURever home. Their personality traits will start to show, as well as any behavior issue that may be present.

**3 Months:**

For most fur babies, 3 months is enough time to finally be comfortable and begin to build trust and a true bond. A sense of security may be present & a set routine will help this process.

Please know that this is not the rule with every rescued or adopted pet, as some may need 6 months to a year to adjust & adapt, depending on MANY factors. Age of animal, what type of an environment did they come from?

## DOG PARKS

### BARBER PARK

3701 Gatlin Ave. | Orlando

### BARNETT PARK

4801 W. Colonial Dr. | Orlando

### CYPRESS GROVE PARK

290 Holden Ave. | Orlando

### DOWNEY PARK

10107 Flowers Ave. | Orlando

### DR. PHILLIPS COMMUNITY PARK

8249 Buenavista Woods Blvd. | Orlando

### INDEPENDENCE PARK

5849 New Independence Pkwy. | Winter Garden

### LESTER MANDELL PARK

3500 Central Florida Pkwy. | Orlando

### MEADOW WOODS COMMUNITY PARK

1751 Rhode Island Woods Cir. | Orlando

### SUMMERPORT PARK

14491 Bridgewater Crossings Blvd. | Windermere

### WEDGEFIELD PARK

20425 Mansfield St. | Orlando

### WEST ORANGE PARK

12400 Marshall Farms Rd. | Winter Garden

### YOUNG PINE COMMUNITY PARK

5201 Young Pine Rd. | Orlando

### YUCATAN PARK

6400 Yucatan Dr. | Orlando





*• Shop • Dine  
• Play  
• Stay*

**LOCALLY**



*...and support the community you live in!*